

01	Defining Lines	26
	Dorothy Jacobs	
02	Elevating Tourism in the Highlands	36
	Zhoufei Zhu	
03	Feeding the Highlands	50
	Stefan Molinaro	
04	Cultivation Island	58
	Anna Darling	
05	City Trail	66
	Lucy Whitacre	
06	The Tortoise's Neck	76
	Luke van Tol	
07	Park City Park	90
	Andrew Ward	
08	Multi-Functional Pier	98
	Yini Tang	

PARK CITY PARK

Andrew Ward

The town of Puerto Baquerizo Moreno sits on the southwestern tip of San Cristóbal Island, bordered on all sides by the Galápagos National Park. Although it is a city surrounded by a park, the residents have little access to the park due to mandatory fees and limited access points. This project creates a park within and for the city, providing residents with opportunities to experience the unique geology and ecology of the island on their own terms. The new park also provides the town with needed urban spaces, without infringing on or being constrained by the rules of the GNP. The park takes form by connecting existing institutions and their under-utilized land throughout the town. A variety of programs throughout the park will relate the existing institutions to the needs of the surrounding neighborhoods. By manipulating the topography, places of water collection and re-direction will help to protect the town from flooding during heavy rains. The build-up of soil and walls will create microclimates that will support species from a variety of ecozones on the island, allowing residents to experience and engage with the specific environments that make their island so unique.

Site Analysis

ACCESS TO NATIONAL PARK

- Visitors must be accompanied by a Naturalist Guide authorized by the GNP.
- Many residents have never visited the GNP due to lack of access and cost.

LAND DESIGNATION ON SAN CRISTÓBAL

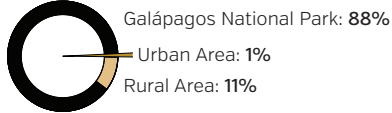

Design Strategies

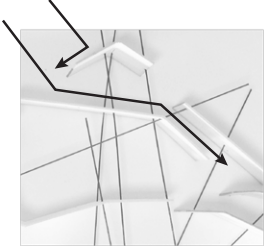

Divert



Collect

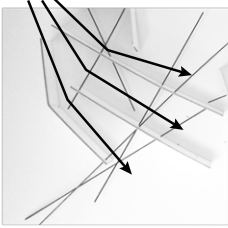

Spread

Connecting Institutions and Activating Underutilized Land



Charles Darwin Foundation
Current use by highschool programs, and student Ranger club. Some native species planting and education.



City Park
Basketball and Soccer Courts, Ping Pong Hall, Playground, Sunny garden Path, Restrooms



Tourist Pier
Used for transportation and inspection of tourists only between the hours of 7:00 - 7:30 am 3:00 - 3:45 pm



Government Hill
Provincial government offices and police station overlooking town. Limited pedestrian access.



Alejandro Von Humboldt High School
Local high school with neglected unused land. Many existing mature plants on site including Palo Santo, Mesquite, and salt bush.



Waterfront
.5 mile continuous waterfront path with restaurants, shops, and hotels. Frequently used by residents and tourists alike.



Parcels



Connected Parcels



Cross Stitching



Activated Edges



Water Flow



Areas of Holding



Edges of Interception



Framework

Park Design Elements

Framework Plan



Collecting Wetness



Spatial Strategies

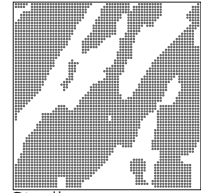

Stroll

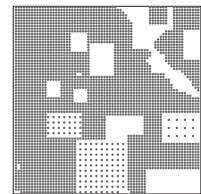

Propagate

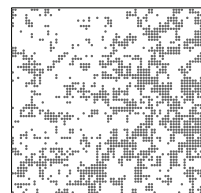

Play



Research

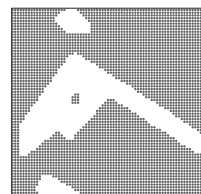

Perform



Program



Ecozones



City Park Zoom In Plan



School and CDF Zoom In Plan

City Park Lot

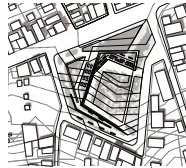

Central Gardens and Recreation Area

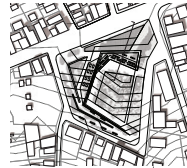

Plaza and Seating

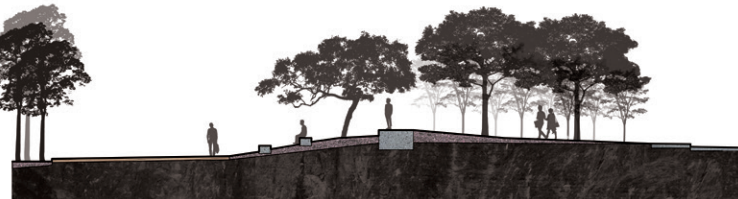

Highschool and Charles Darwin Foundation lot

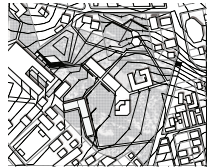

CDF Botanical Gardens

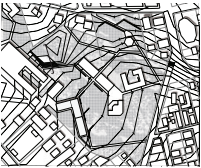

Scalasia Amphitheater

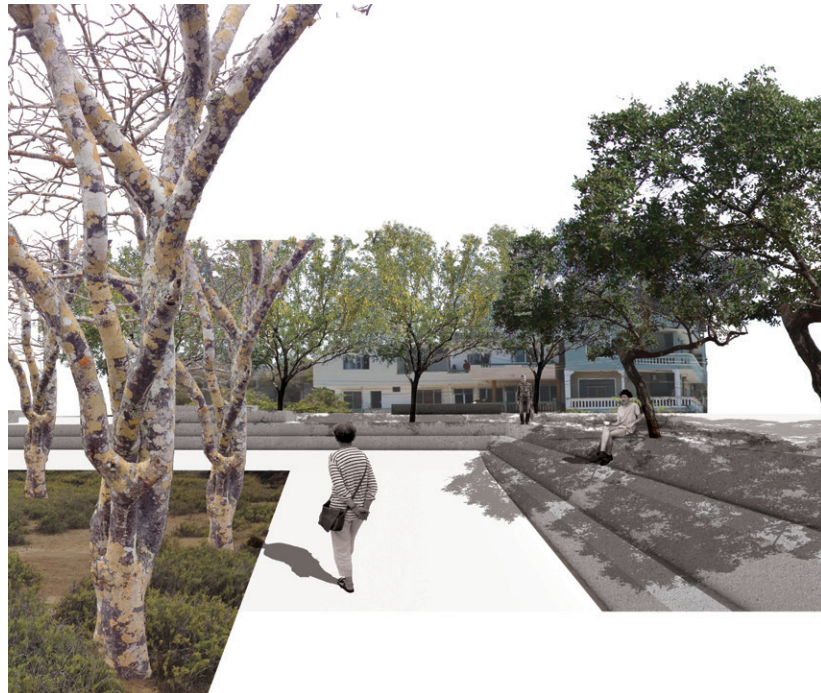

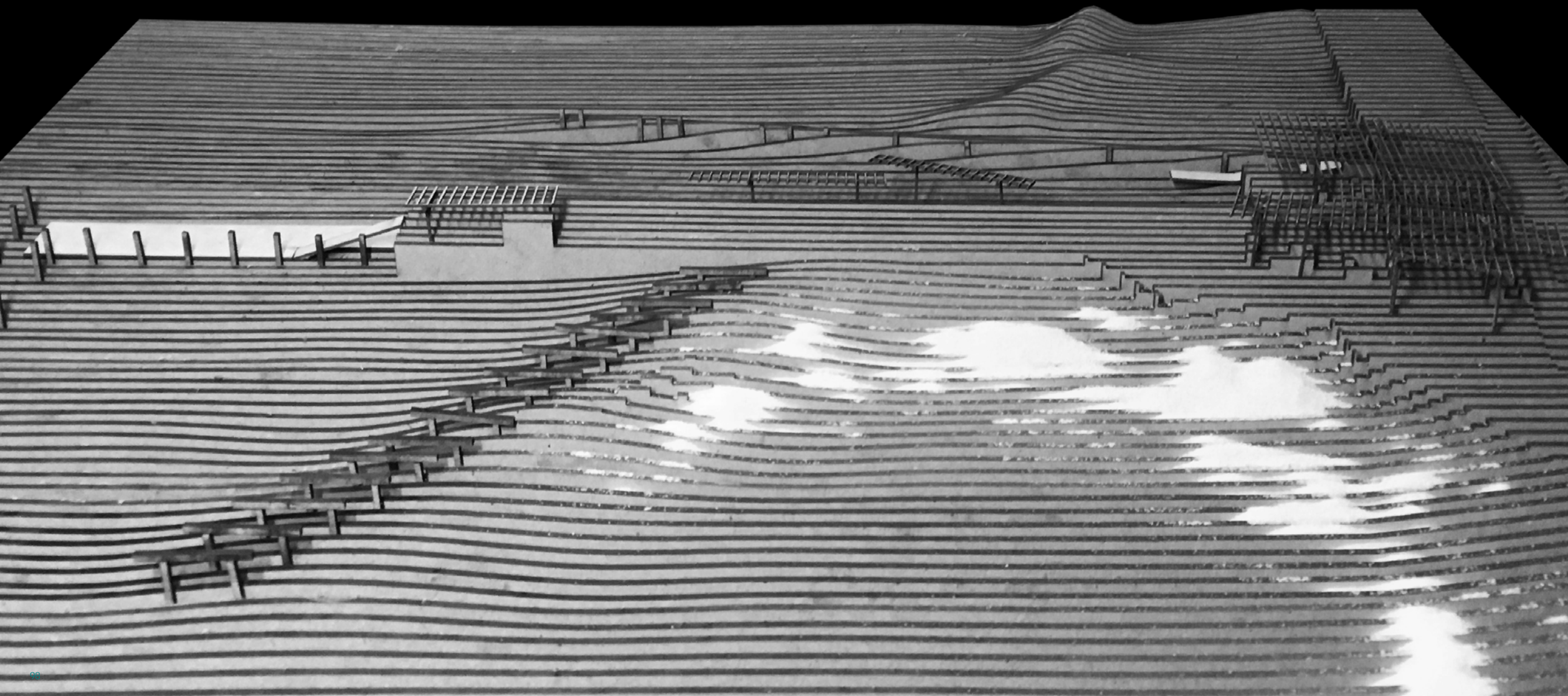

MULTI-FUNCTIONAL PIER

Yini Tang

The Galápagos Islands are famous for their endemic animals, yet much less is known about local people and their experiences with the ecology of the islands. On the flip side, the tourists, especially those who stay on 'boat-hotels,' have many interactions with wildlife but few with human residents. By analyzing the people and product flows through the existing piers at Puerto Baquerizo Moreno, I observed that tourists and locals are separated, and the tourists' piers are underutilized while the fisherman's pier is overcrowded. Furthermore, the current multitude of piers give too much area to boat traffic, thereby encroaching on much-needed sea-lion habitat.

By reorganizing and consolidating activities to the town's largest pier, which also leads to the town center, this project aims to create more encounters between tourists and locals, and give more visibility to the exchange of local products. This "mega-pier" includes transportation of fishes and highland produce, tourist embarking / disembarking, an outdoor market, and a new beach area. By consolidating activities to one pier, other areas can be designed for recreation and animal habitat.

Site Analysis & Operations

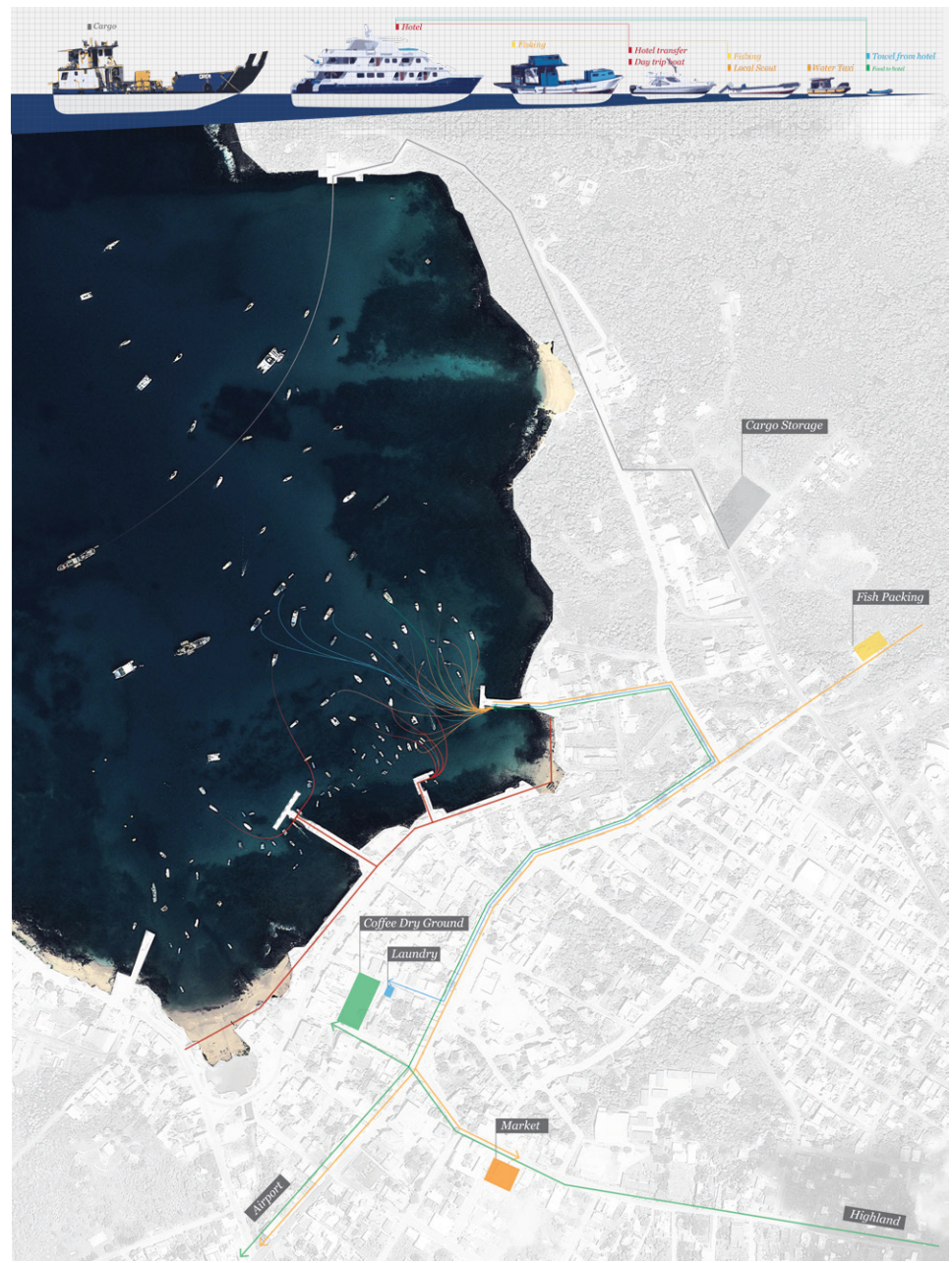

Existing: Disordered Pier Activities

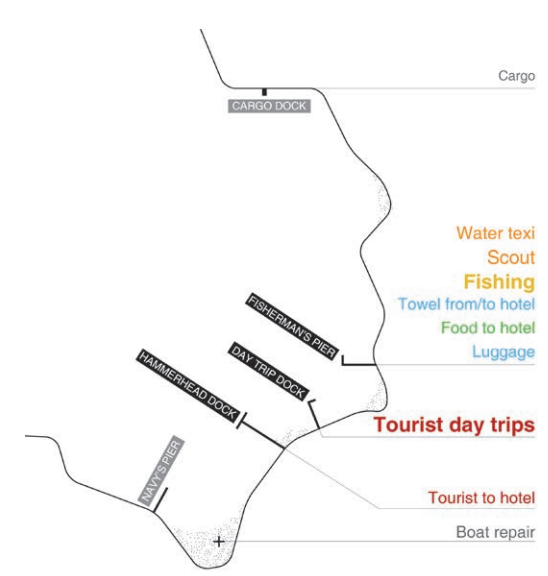

Proposed: Consolidation of Activities & Beach Generation

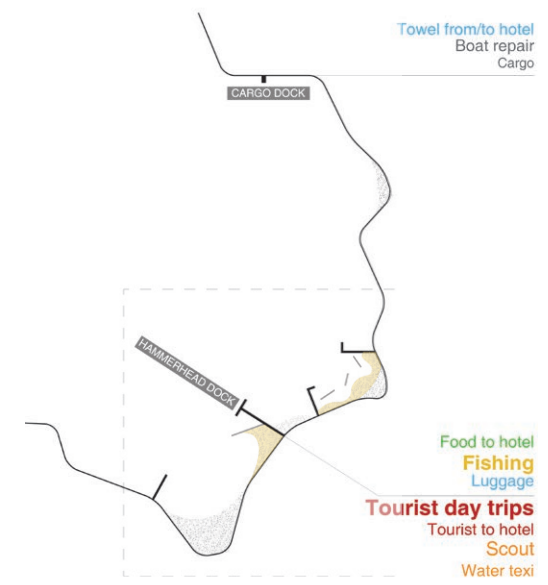

Multi-functional Pier Design

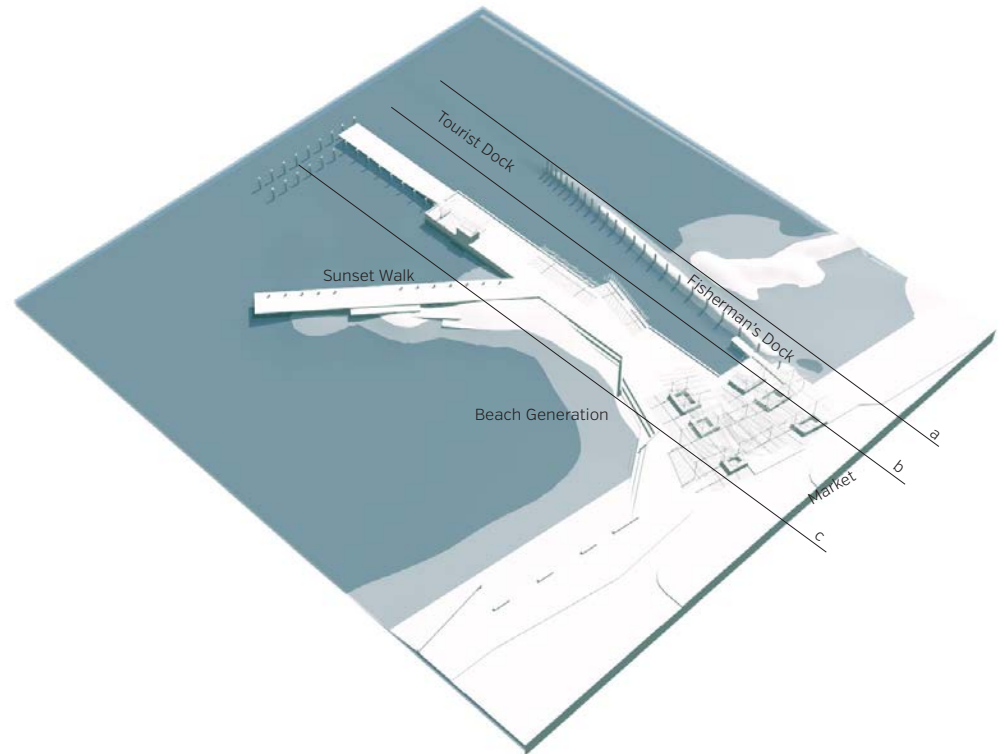

Sections

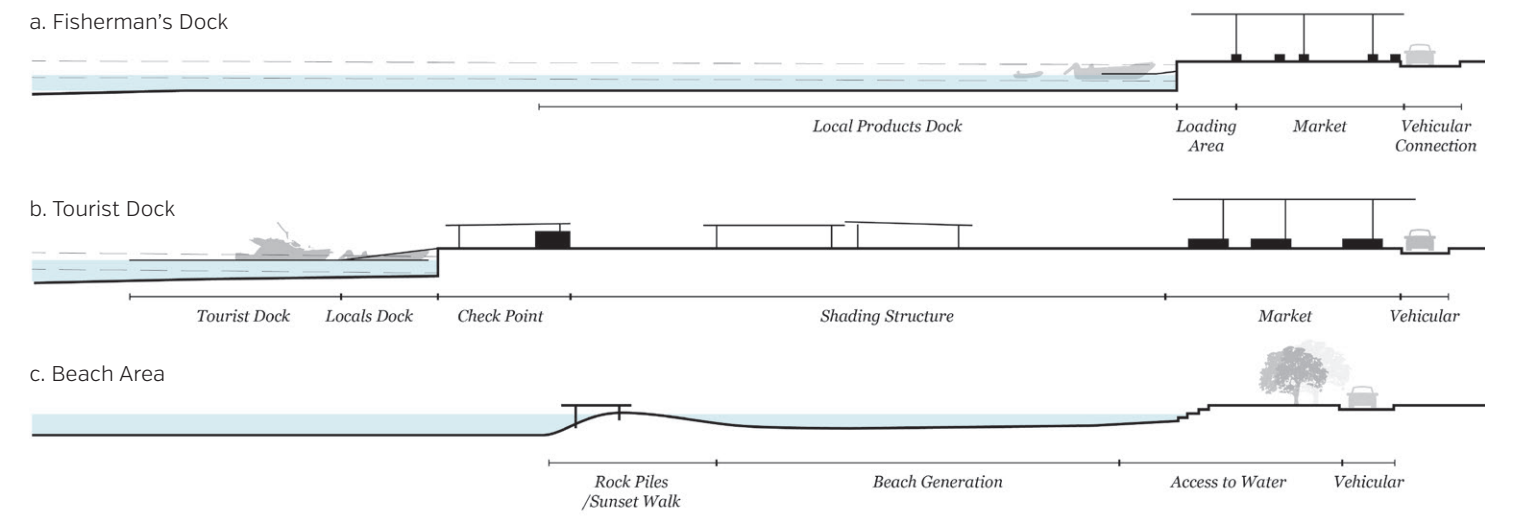

Model

Fisherman's Dock (top) | Tourists' Dock (bottom left) | Beach & Market (bottom right)



Beach Generation over Time

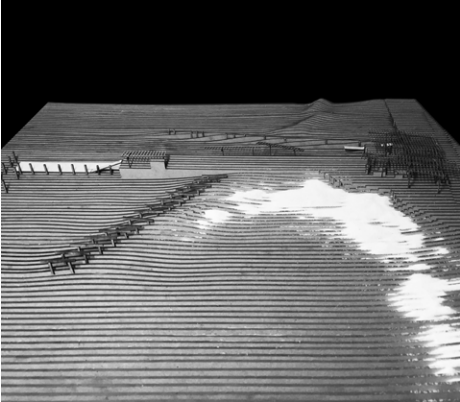
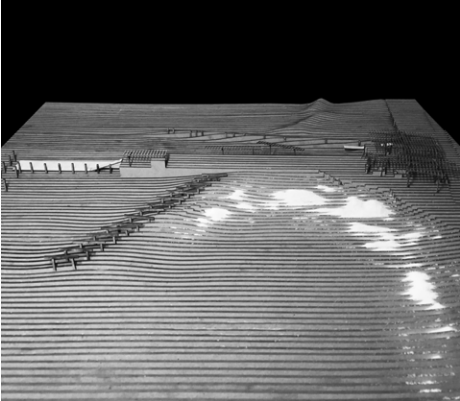
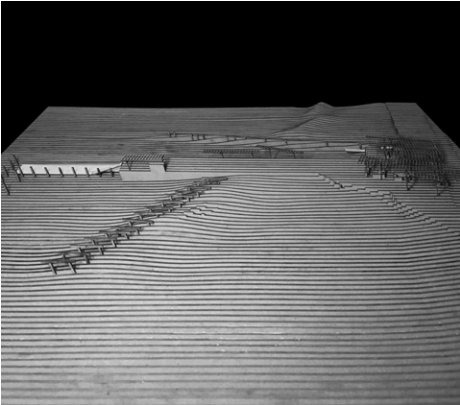

Performance

Fisherman's Dock (top) | Tourists' Dock (bottom left) | Beach (bottom right)

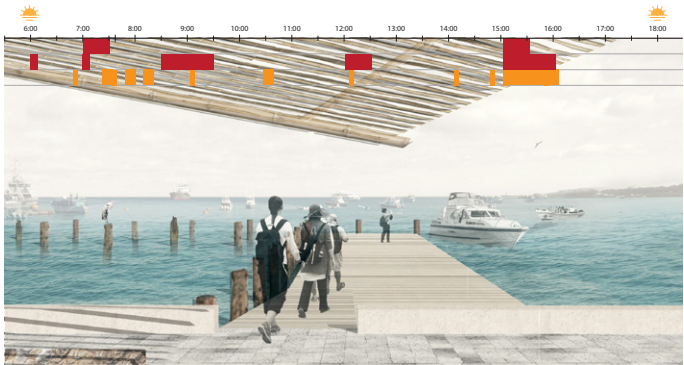

Beach Generation Concept Design

Beach Generation Principle

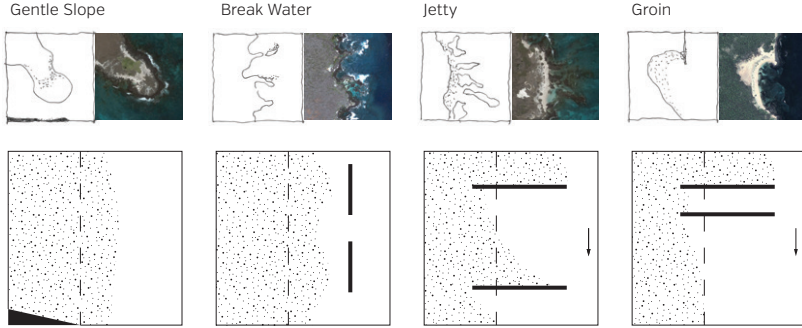

Study Model

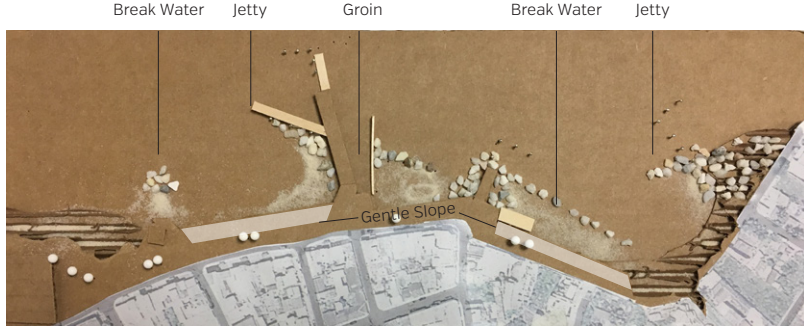

Beach Generation Concept Design

Sequential plans show beach generation and tidal changes over time.

Existing Condition



Initial Operation



Shoreline Material Study

Before

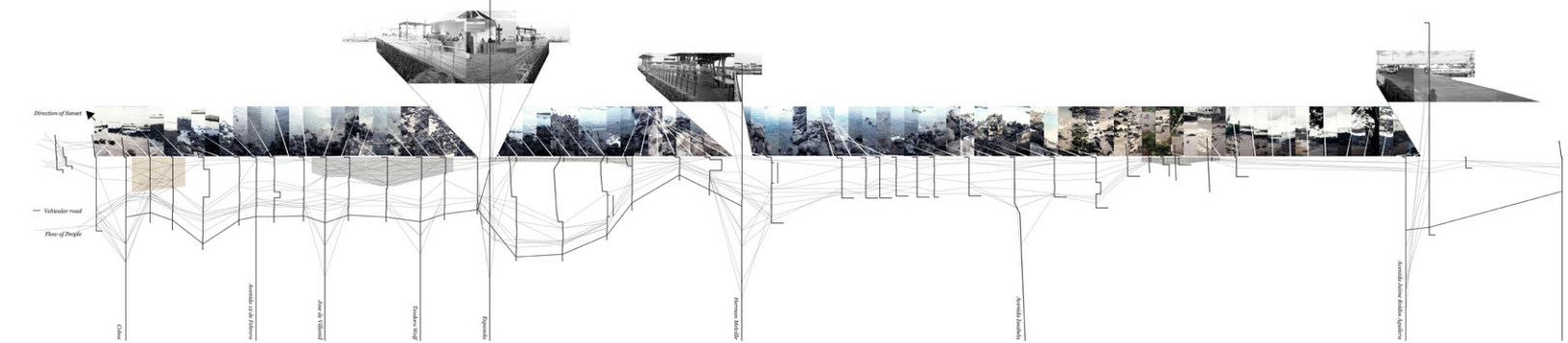

After

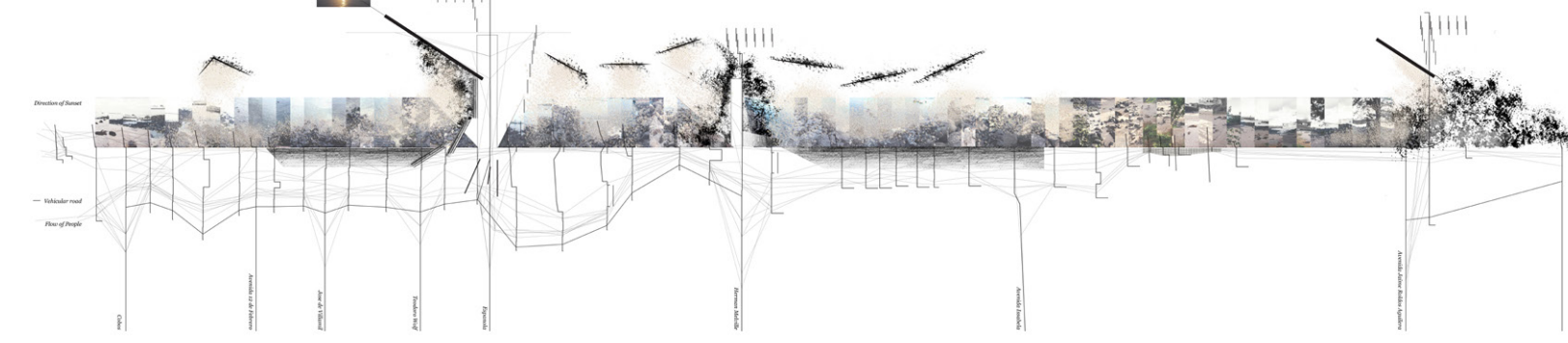

Beach Generation





Yang An
 Nikki Chang
 Ya Chen
 Anna Darling
 Sihong Deng
 Bo Dong
 Qin Fang
 Miriam Grunfeld
 Dorothy Jacobs
 Linghui Liao
 Zhexuan Liao
 Stefan Molinaro
 Benjamin Summay
 Yini Tang
 Luke Van Tol
 Andrew Ward
 Lucy Whitacre
 Xiao Wu
 Ao Zhang
 Huiyi Zhang
 Zhoufei Zhu

FANTASY ISLAND

This book is comprised of select projects that best represent the range of ideas explored in this studio at the University of Pennsylvania. The studio was guided by Karen M'Closkey and focused in and around Puerto Baquerizo Moreno on San Cristóbal Island, Galápagos Islands, Ecuador. I wish to thank all of my fabulous students who went on this journey with me. The students and I would like to thank Michael Weisberg, Ernesto Vaca, Penn's Program in Environment Humanities, the Stuart Weitzman School of Design at the University of Pennsylvania, and the many wonderful people we met along the way. Special thanks to Zhexuan Liao, Yang An, and Dorothy Jacobs for book design.

